

October 24, 2024
La Marchea: Puerto Princesa

Presented by
**Kaluha Realty and
Development Corp.**

Project Profile



Architect's Perspective

Table of Contents

Story About Us	03
A Sense Of Community	05
Message From The Chairman	06
Mission & Vision	07
Meet Our Team	08
House Models	09
Natural Amenities	14
Location	15
Contact Us	16

Inspired by the Palawan Hornbill (*Anthracoceros marchei*) a large forest bird endemic to the Philippines), it is situated in Sicsican, Puerto Princesa City, surrounded by lush greenery and a tight-knit agricultural neighborhood called "Agri-Hood".



Story About Us

At La Marchea, homeowners get to enjoy the best of three worlds:

- Modern Living in Nature
- Sustainable Neighborhood
- Marketplace for Economic Growth

October 24, 2024

La Marchea: Puerto Princesa

Presented by

Kaluha Realty and Development Corp.

03



Welcome to your greener and better life.

Let La Marchea be the place for you to build a
prosperous life as you live in your own piece of paradise.



A Sense of Community

At La Marchea, we encourage community-building and sustainable living. Our charming marketplace provides a warm and inviting atmosphere, allowing you to not only shop and dine but also support local businesses. By patronizing these establishments, you contribute to the growth of thriving agriculture and local marketplace vendors, supporting economic development making the community prosper together.

Immerse yourself in an environment that fosters a sense of community and belonging—a place where you can connect with like-minded individuals and form lasting friendships.

Together, we can create a vibrant, resilient, & thriving community that enriches the lives of everyone.

Message From Our Chairman

At La Marchea, we understand the heart of returning home to the Philippines. When you come back, where will you go?

We've created a community that fosters what we call a cooperative. Why? Because we will be the ones to support and empower you. We're here to guide, ensuring that you can set up your own businesses in the best way possible—through a cooperative.

At La Marchea, we don't just provide homes; we offer a life filled with possibilities—where lifestyle, productivity, and growth go hand in hand. It's time to elevate the lives of our people and to come home to your own piece of paradise.

Our dream? To see fewer and fewer OFWs, with more choosing to build their lives back home.

This community we're building, La Marchea, is the answer to the challenges faced by our OFWs.

Let's embrace this holistic approach to transform lives and create a bright future for everyone in our community.

Living, naturally.

Mission

To build a quality, upmarket eco-homes for the Filipino families, both local and abroad, in the forest city of Puerto Princesa, Palawan

Mission & Vision



Vision

Our vision is to create homes that promote community and preservation of mother nature.

Meet Our Team



SC&A Architects
Planners

Master Planner



Barchan +
Architecture

House Designer



Meinhardt

Engineering Designer



Design
Coordinates Inc.

Project Manager



Kaluha Realty
Development Corp.

Developer



Architect's Perspective

House Models



Our homes are built with passion and purpose, made sustainably in harmony with nature.

La Marchea offers four distinct house models, each carefully designed to meet your specific needs and preferences. For those seeking ample space, our Single Attached model boasts a generous area of 91 sqm, providing plenty of room for comfortable living. If you prefer a shared living space, our Duplex model offers a spacious layout of 90 sqm, allowing you to enjoy the benefits of a connected yet independent lifestyle. If you appreciate the charm of a townhouse, we have two options available. Townhouse 1 features a 63 sqm lot area, providing a cozy and inviting atmosphere for you to call home. On the other hand, Townhouse 2 offers a slightly smaller lot area of 50 sqm, perfect for those who value efficiency without compromising on style.

Single Attached

Boasts a generous area of 98.66 sqm, providing plenty of room for comfortable living.



Architect's Perspective



Architect's Perspective

La Marchea

Single Attached

98.66 sqm

Duplex

A spacious 90 sqm unit, allows you to enjoy the benefits of a connected yet independent lifestyle.

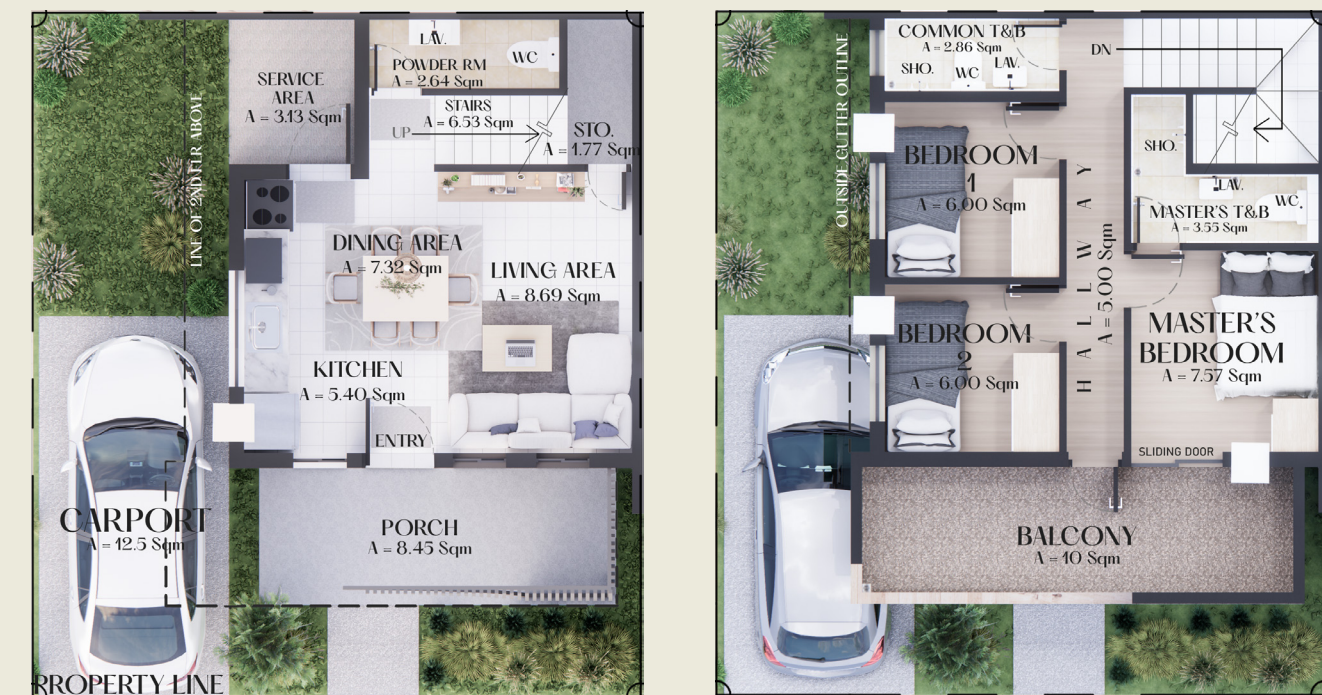

La Marchea

Duplex

90 sqm

Townhouse 67

A 67 sqm lot area, providing a cozy and inviting atmosphere for you to call home



Architect's Perspective

La Marchea

Townhouse 67

67 sqm

Architect's Perspective

Townhouse 50

A slightly smaller lot area of 50 sqm, perfect for those who value efficiency without compromising on style.

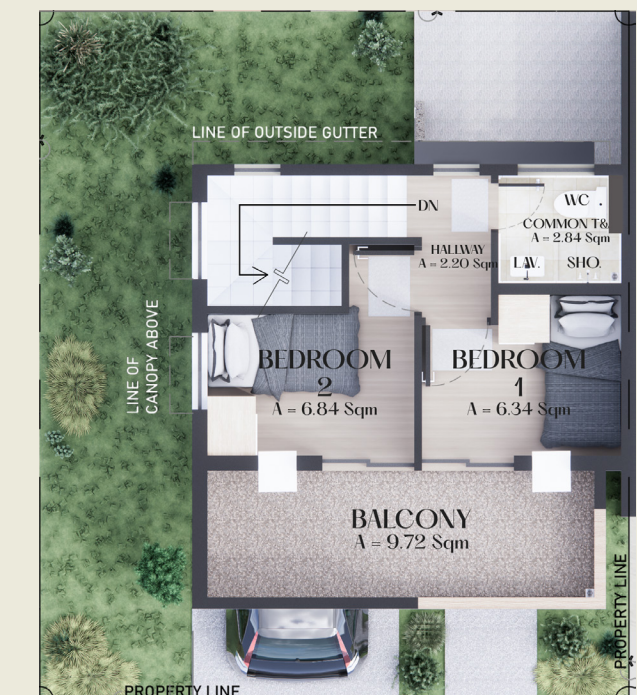

Architect's Perspective

La Marchea

Townhouse 50

50 sqm

Natural Amenities

01 Marketplace

Purchase fresh produce, household items, and various other goods, while also promoting the local economy by providing a platform for local vendors and farmers to sell their products.

02 Bahay Kubo Garden

Discover the joy of harvesting fresh produce, where you can cultivate your own nutritious vegetables.

03 Botanika Herbal Garden

An herb garden provides a fragrant and therapeutic space to explore

04 Lagoon

Adds a touch of tranquility, inviting you to unwind and find solace in its serene waters.



Architect's Perspective

Location

Barangay Sicsican in Puerto Princesa City, Palawan is 11km away from the city proper. This close proximity allows for easy access to various amenities such as schools and hospitals and the airport.

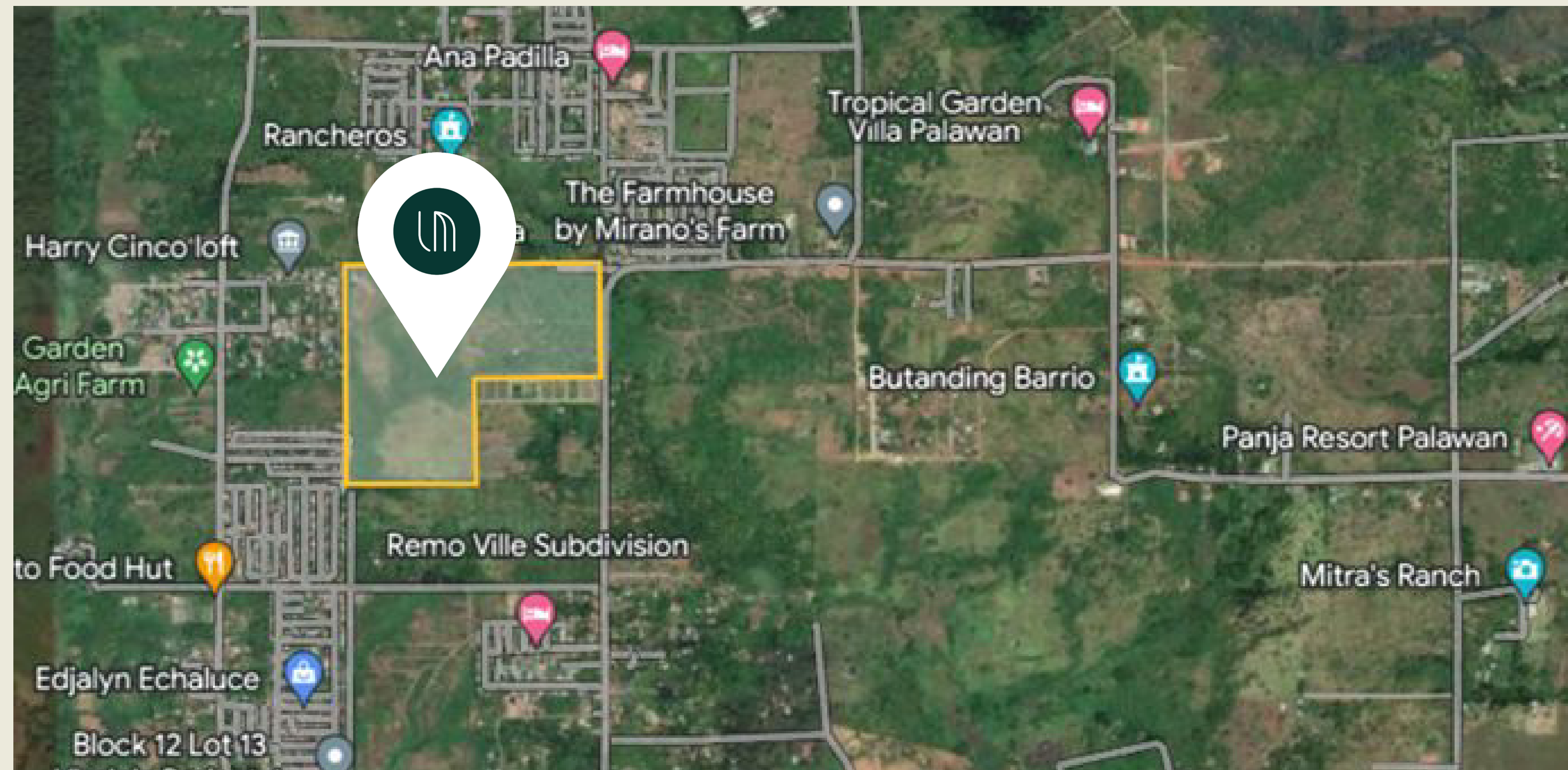

Contact Us



La Marchea

Email: salesandmarketing@lamarchea.ph

Website: lamarchea.ph

Puerto Princesa Marketing Office:

Manila Office:

Contact Numbers:

Permit No.: TLS No. R4B-005

Unit 208 2nd Floor, Green Building

Unit 508, Admiralty Building, Madrigal Business Park,

(02) 8640 4585 | +63 962 566 8217

Date Approved: June 27, 2024

132 National Highway, San Pedro, PPC SJD CENTER

Ayala Alabang, Muntinlupa 1780